

# **M-torQ**<sup>TM</sup> Controls India

## **MANUAL OVERRIDE DECLUTACHABLE GEAR BOXES IN CAST IRON MOR SERIES**

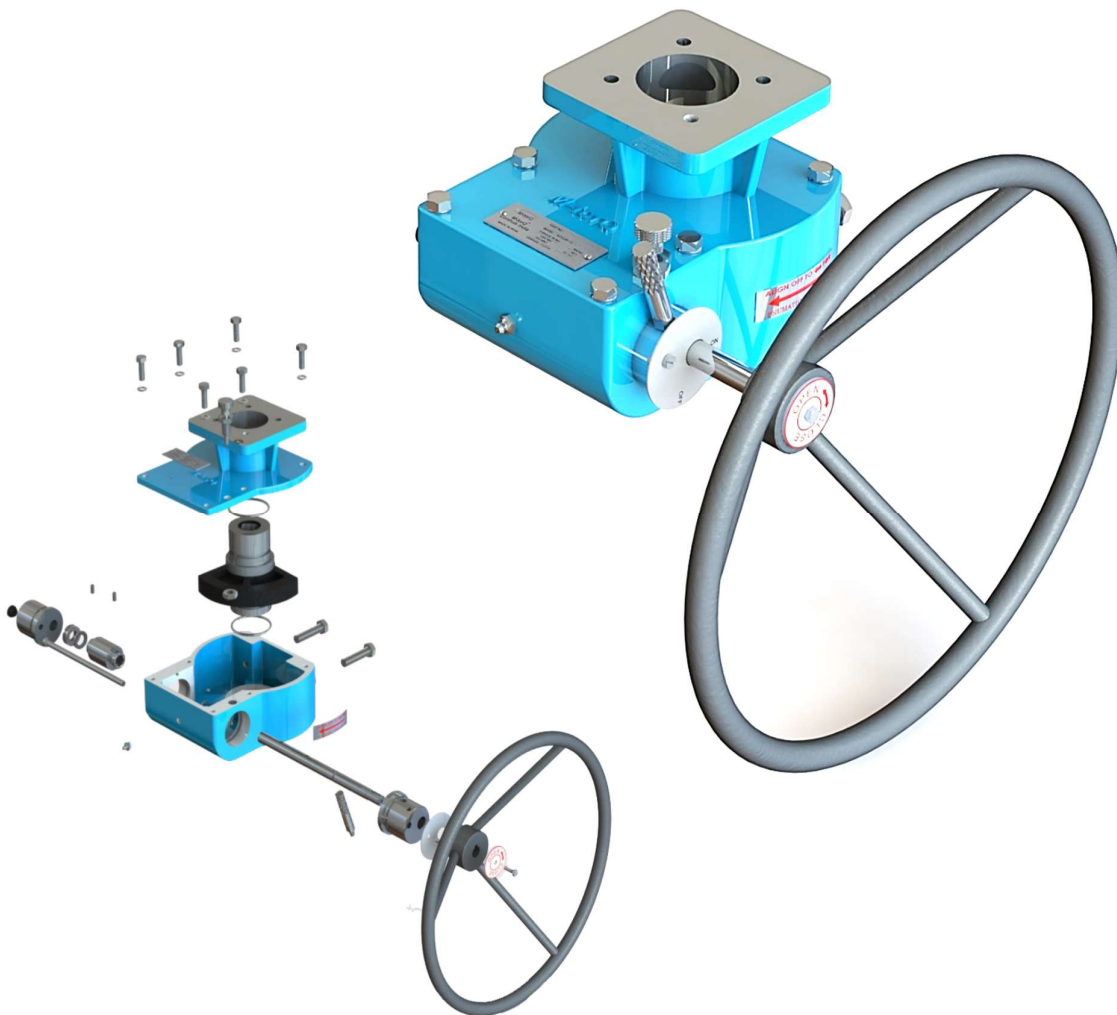

**ENGINEERING-INNOVATION-SOLUTION-**

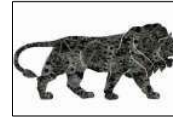

## **M-torQ** De-clutchable Gear boxes for actuations-

### **CAST IRON SERIES-**

#### **Introduction: -**

The **M-torQ** Controls Manufactures Manual Override gearboxes series in Cast iron as per customer's requirement and having torque load of 100 NM to 35000 NM. We are closely related to Oil, Gas sector and chemical industries. We are also following ASME standards/BS standards/ISO standards depending upon the work environment onshore and offshore.

#### **Features**

- \* Cast Iron body.
- \* Series of models up to 35000 Nm torque.
- \* SGI500/7 worm wheel & EN8 worm.
- \* Mounting flanges conforming to ISO5211.
- \* Hand wheel will be provided as per customers' requirements in Mild Steel (IS 2062 GRADE -B Grade.) and Fabricated. (MS grade with Epoxy painted).
- \* Epoxy painting / Powder coating as per customer's requirement.
- \* Material identification for traceability.
- \* Stroke  $0^{\circ}$  to  $90^{\circ} \pm 5^{\circ}$ .
- \* Smooth and easy Clutch and Declutch mechanism.

#### **Specification**

- \* IP54 and IP65 (IP 67 & IP68 optional as per Customer requirement).
- \* Lubrication used SERVO GEM AP2/AP3.

#### **Options**

- \* Locking arrangement.
- \* High temperature variant up to  $+160^{\circ}\text{C}$ .
- \* Low temperature variant up to  $-55^{\circ}\text{C}$ .

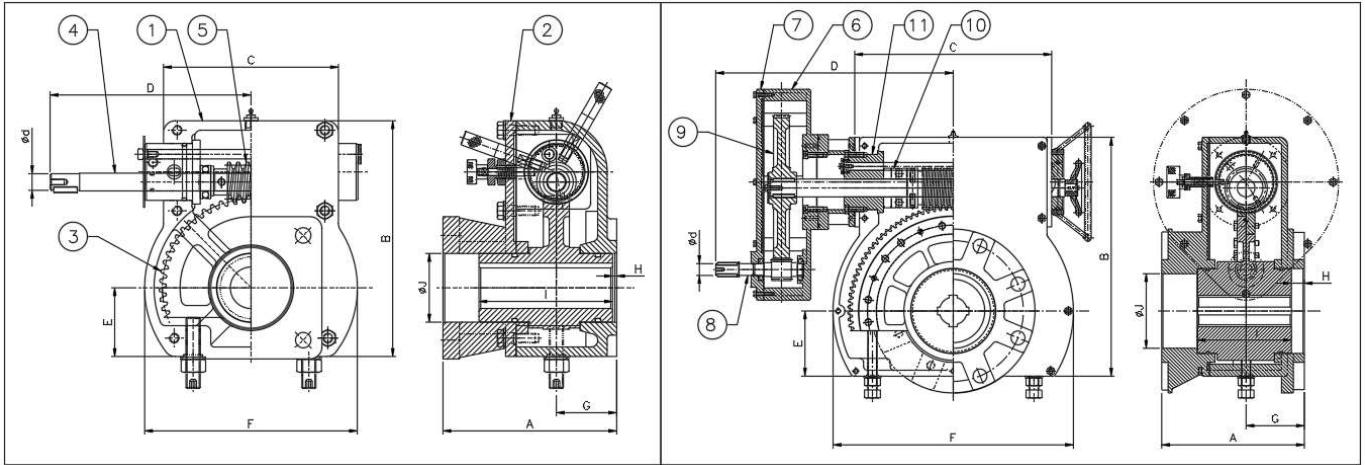

Sr. No.	Description	Material	US Standard	IS Standard
1	G.B. Housing	Cast Iron	ASTMA4835B/40B	IS210
2	G.B. Top Cover	Cast Iron	ASTMA4835B/40B	IS210
3	Worm Wheel	Ductile Iron	ASTMA536 80-55-06	IS1865
4	Worm Shaft	EN8/EN19	SAE1040/SAE4140	48C8/C55
5	Worm	EN8/EN19	SAE1040/SAE4140	48C8/C55
6	Reducer housing	Cast Iron	ASTMA4835B/40B	IS210
7	Reducer cover	Cast Iron	ASTMA4835B/40B	IS210
8	Pinion	EN8/EN19	SAE1040/SAE4140	48C8/C55
9	Spur gear	Ductile Iron	ASTMA536 80-55-06	IS1865
10	Thrust Bearing	STD	STD	STD
11	ECC. Bush	Cast Iron	ASTMA4835B/40B	IS210

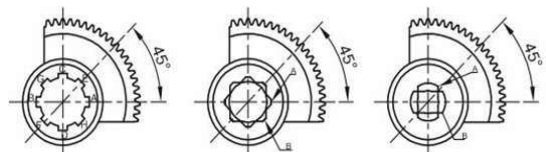

VIEW FROM TOP AT CLOSE POSITION

Note: - For Model up to MTOR -3.5 SINGLE REDUCTION & MODEL

ABOVE MTOR3.5 DOUBLE REDUCTION.

M-torQ Models	Rate of Output Torque (Nm)	Mechanical Advantage $\pm 10\%$	Ratio	Turns to Close	Valve Mounting ISO 5211	Max Drive Bore	Max. Square	Actuator Mounting ISO 5211	Recommended Hand wheel (mm)	A	B	C	D	E	F	G	H	I	J	ød
MTGOR-0.25	100	9	38:1	9.5	F04, F05, F07	ø18	17	F04, F05, F07	ø150	97	112	98	108	67	84	34.5	5	50.5	ø22	10
MTGOR-0.5	250	9	38:1	9.5	F05, F07	ø25	17	F05, F07	ø175	83	121.5	105	127	41	105	29	5	74	ø30	12
MTGOR-1	650	9	38:1	9.5	F07, F10, F12	ø25.5	22	F07, F10, F12	ø250	112	177.4	148	165	60	148	42	5	87	ø42.5	14
MTGOR-1.5	1000	14.5	60:1	15	F10, F12	ø38	30	F10, F12	ø350	147	199	148	170	58	180	51	3.5	113	ø58	14
MTGOR-2	1500	17	70:1	17.5	F10, F12, F14	ø50	40	F10, F12, F14	ø400	119.5	248	186	225	73	267	44.5	4.5	95	ø68	16
MTGOR-2.5	2500	17	80:1	20	F12, F14, F16	ø58	45	F12, F14, F16	ø500	168	277	210	190	77	274	64	7	127	ø75	18
MTGOR-3.5	3500	22	90:1	22.5	F16, F25	ø80	55	F16	ø500	203	327	260	267	90	340	80	6	125	ø75	22
								F25		203										
MTGOR-5	5000	50	264:1	66	F16, F25	ø80	60	F16, F25	ø600	185.5	379.5	314	326	100	345	70	9.5	132	ø82	20
										193.5										
MTGOR-7.5	7500	70	348:1	87	F25, F30	ø100	70	F25, F30	ø600	223	377	300	398	105	370	65.5	5	139.5	ø106	22
MTGOR-10	10000	85	405:1	101.25	F25, F30	ø100	70	F25, F30	ø750	227	458	332	436	100	402	77	9.5	162	ø118	20
MTGOR-15	15000	95	460:1	115	F25, F30, F35	ø110	75	F25, F30, F35	ø750	291	494	362	483	155	492	115	7	201	ø130	30
MTGOR-35	35000	260	746:1	195	F25, F30, F35	ø160	100	F25, F30, F35	ø750	362	605	500	603	165	610	148	33	238	ø189	30

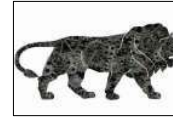

# M-torQ<sup>TM</sup> Controls India



## CERTIFICATE

Management system as per  
ISO 9001 : 2015

The Certification Body TÜV INDIA hereby confirms as a result of the audit, assessment and certification decision according to ISO/IEC 17021-1:2015, that the organization

**M TORQ CONTROLS INDIA**  
Plot No. B-3-E10-19(3), Pimpri Industrial Area,  
Village Bhosari, MIDC, Pune - 411 026  
Maharashtra,  
India



operates a management system in accordance with the requirements of ISO 9001:2015 and will be assessed for conformity within the 3 year term of validity of the certificate.

Scope -

**Design, Manufacture and Supply of Limit Switch, Gear Box & Actuator**

Certificate Registration No. **QM 03 02834**  
Audit Report No. **Q 10869/2021**

Valid from **10.07.2021**  
Valid until **09.07.2024**

Certification Body  
at TÜV INDIA PVT. LTD.

Mumbai, 10.07.2021

TUV India Pvt. Ltd., 801, Raheja Plaza - 1, L.B.S. Marg, Ghatkopar (W), Mumbai - 400 086, India [cert.hq@tuvindia.co.in](mailto:cert.hq@tuvindia.co.in)



Distributor's address:

Corporate & Factory address

**M-torQ<sup>TM</sup> Controls India**

Plot No. B-3, E-10,19 Industrial Area MIDC Bhosari.

Phone: +91 20 27400989.99

PUNE -411026 (Maharashtra INDIA)

Mobile: +91 9422007317

E-mail: [sales@mtorqindia.com](mailto:sales@mtorqindia.com)

[mtorqindia@gmail.com](mailto:mtorqindia@gmail.com)

